

NOTE

1. DRAWINGS MUST NOT BE SCALED; CHECK ALL DIMENSIONS ON SITE BEFORE ORDERING MATERIALS OR PUTTING WORK IN HAND
2. THE ARCHITECT MUST BE NOTIFIED OF ANY DISCREPANCIES IMMEDIATELY
3. IF IN DOUBT ASK!

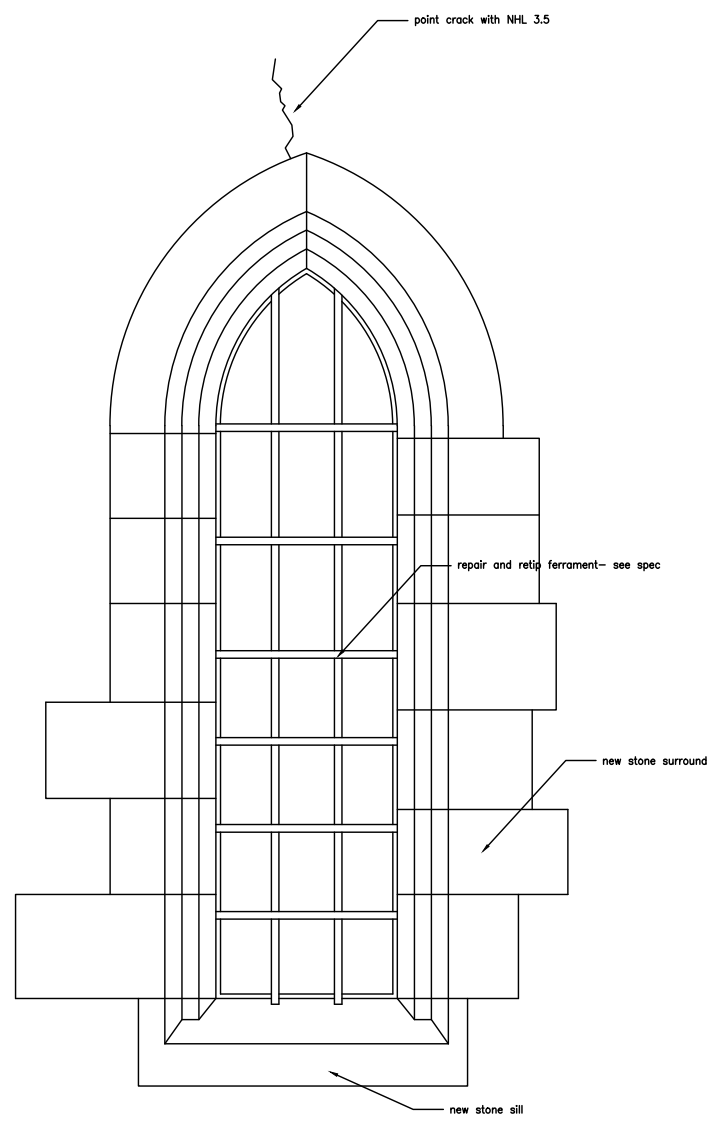

EXTERNAL ELEVATION WSII 1:10

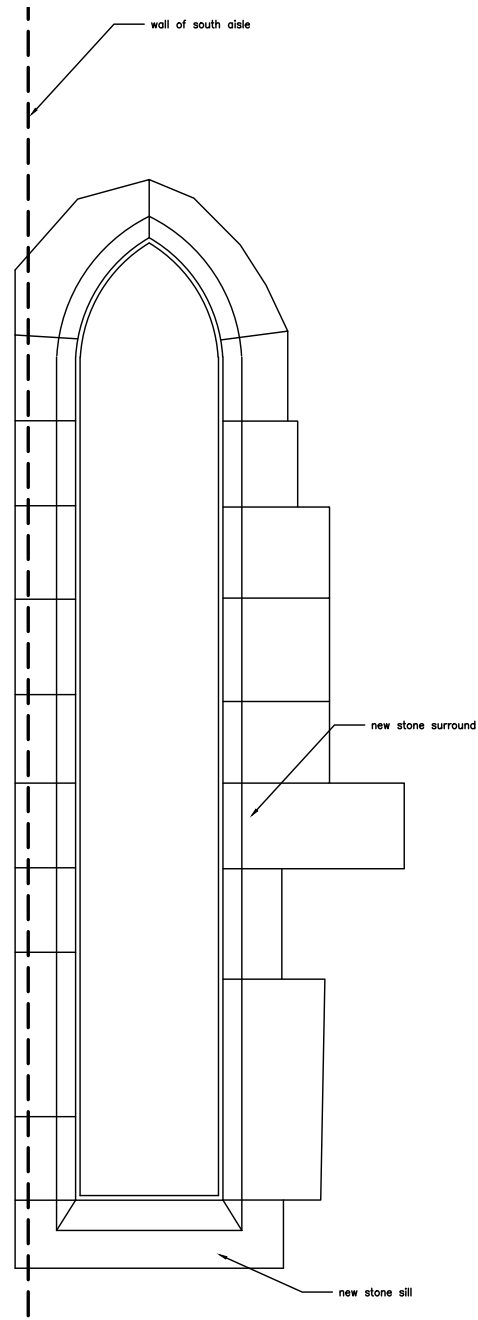

EXTERNAL ELEVATION WSIII 1:10

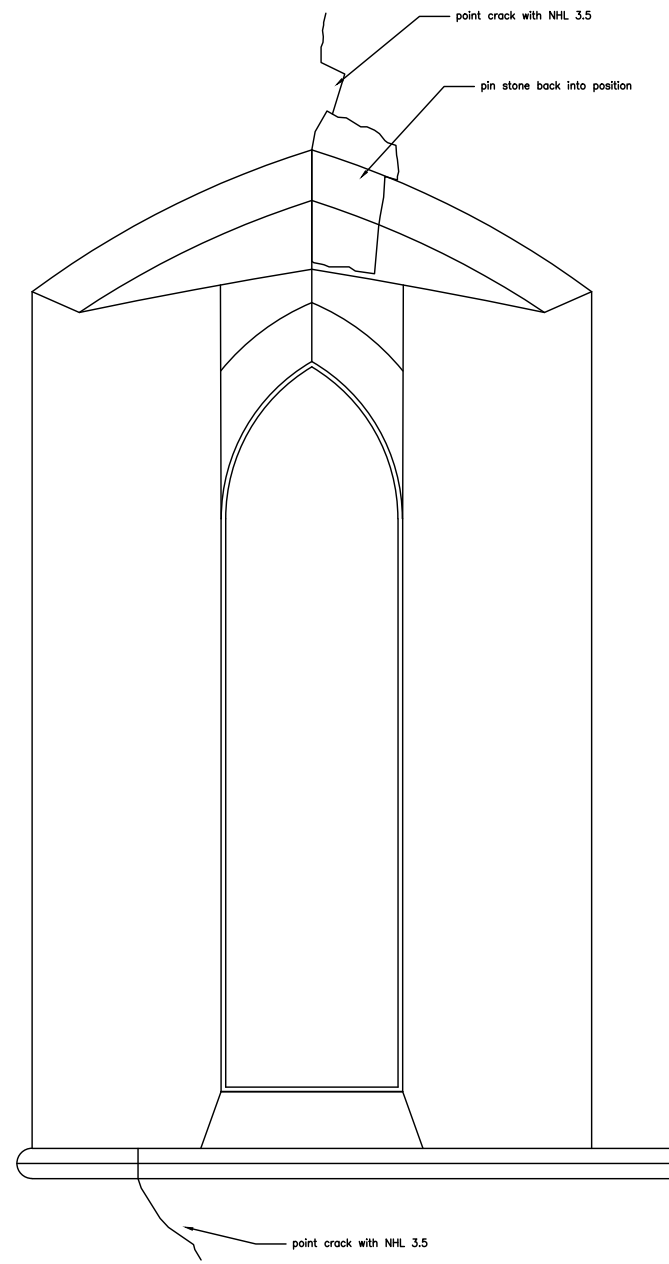

INTERNAL ELEVATION WSII 1:10

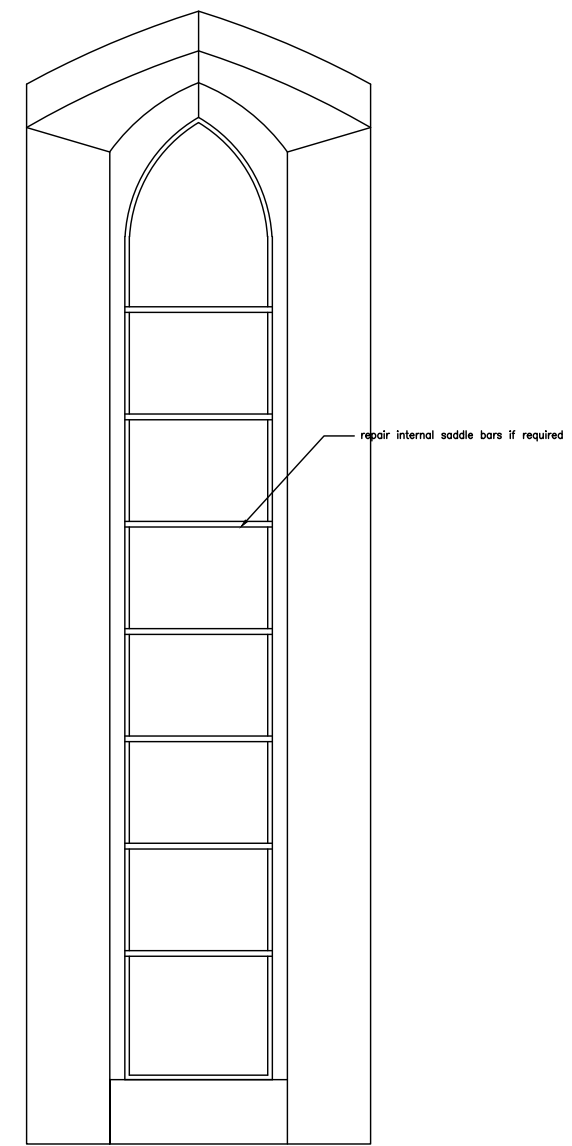

INTERNAL ELEVATION WSIII 1:10

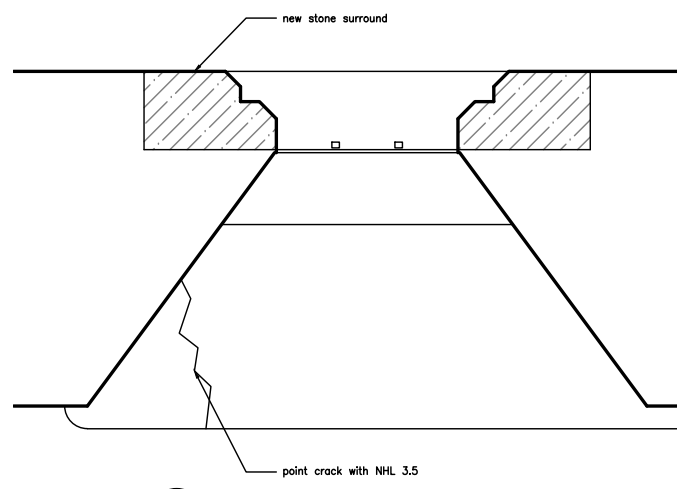

SECTION DETAIL WSII

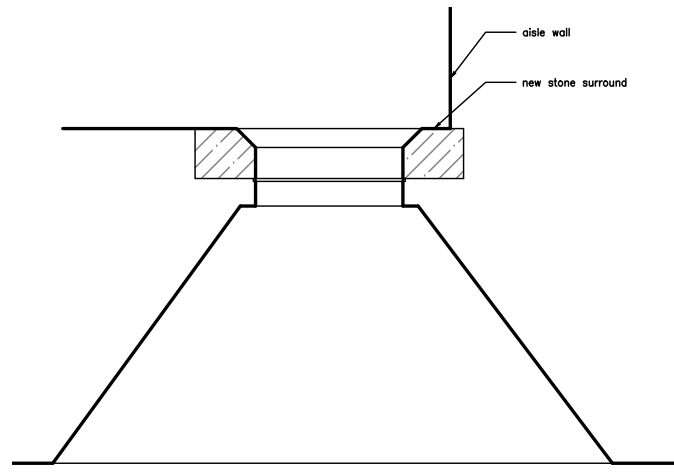

PLAN DETAIL WSIII

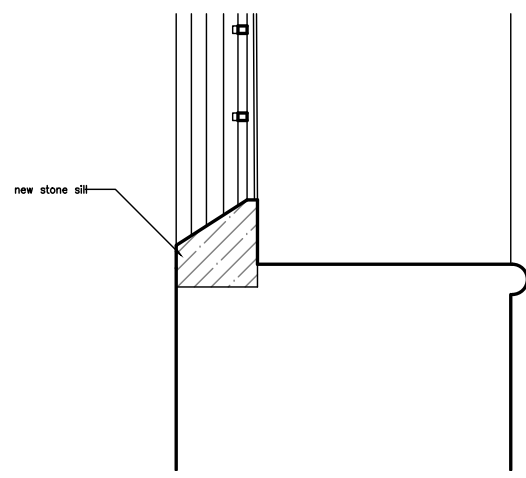

SECTION DETAIL WSII

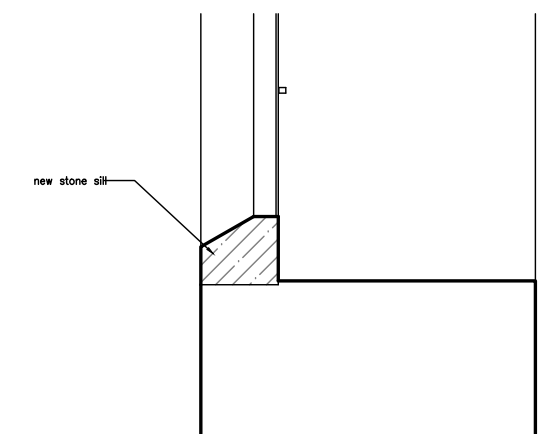

SECTION DETAIL WSIII

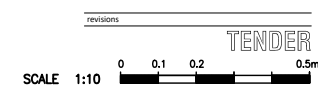

client: St Mary Gilston
 job title: South Chancel Windows
 architect: Jeremy Lander : Architect
 77 North Street Burwell CB25 0BB 07813 03292
 jeremy.da.lander@gmail.com
 drawing title: Proposed Repairs
 scale: 1:10 @ A1
 size: A1
 drawn: JL
 date: Oct20
 drawing no.: 200905.001
 © Jeremy Lander Architect